

INDEX

LINE			
		Br. No. 47.6, Fosston	5
ST. CLOUD TO SAUK CENTRE	1	Br. No. 325 ERSKINE	5
SAUK CENTRE TO ALEXANDRIA	2		
ALEXANDRIA TO FARGO	3	BARNESVILLE TO CROOKSTON	
FARGO TO GRAND FORKS	4	Br. No. 45.7, Ada	6
CASS LAKE TO CROOKSTON Jct.	5	Br. No. 82.0, Crookston	6
BARNESVILLE TO CROOKSTON	6		
CROOKSTON TO NOYES	7	CROOKSTON TO NOYES	
CROOKSTON TO DEVILS LAKE	8	Br. No. 82.7, Crookston	7
TILDEN Jct. TO WAREROAD	9	Br. No. 47.1, Stephen	7
GRAND FORKS TO NECHE	10	Br. No. 71.3, Hallock	7
GRAFTON TO WALHALLA	11	Br. No. 76.1, Northcote	7
NOYES TO WINNIPEG	12		
		CROOKSTON TO DEVILS LAKE	
		Br. No. 107.0, Grand Forks	8
		Br. No. 42.8 PETERSBURG	8
		TILDEN Jct. TO WAREROAD	
STRUCTURES		Br. No. 75, Red Lake Falls	9
ST. CLOUD TO SAUK CENTRE		Br. No. 13, Red Lake Falls	9
Br. No. 83.2, Albany	1	Br. No. 14, Red Lake Falls	9
Br. No. 85.1, Albany	1	Br. No. 16, Red Lake Falls	9
Br. No. 99.6, Melrose	1	Br. No. 180, Roseau	9
SAUK CENTRE TO ALEXANDRIA		GRAND FORKS TO NECHE	
Br. No. 119.6, Osakis	2	Br. No. 184, Minto	10
Br. No. 120.6, Osakis	2	Br. No. 197, Grafton	10
Br. No. 125.7, Nelson	2	Br. No. 208, St. Thomas	10
Br. No. 128.5, Alexandria	2	Br. No. 234, Bathgate	10
Br. No. 128.7 Alexandria	2	Br. No. 246, Neche	10
		GRAFTON TO WALHALLA	
ALEXANDRIA TO FARGO		Br. No. 38, Cavalier	11
Br. No. 150.6, Melby	3		
Br. No. 155.8, Ashby	3	NOYES TO WINNIPEG	
Br. No. 163.5, Dalton	3	Canadian National Ry. Br., Emerson	12
Br. No. 169.2, Fergus Falls	3	C.P. Ry. Br. No. 31- Assiniboine River Winnipeg	12
Br. No. 172.9, Fergus Falls	3		
Br. No. 174.7, Fergus Falls	3		
Br. No. 25, Fargo	3		
FARGO TO GRAND FORKS			
Br. No. 24.9, Fargo	4		
CASS LAKE TO CROOKSTON Jct.			
Br. No. 90.2, Bemidji	5		
Br. No. 53.5, Lengby	5		
Br. No. 50.0, Lengby	5		

GREAT NORTHERN RAILWAY
DAKOTA DIVISION

INDEX

FOR

CLEARANCE DIAGRAMS

OFFICE OF CHIEF ENGINEER, ST. PAUL, MINN.

CORRECTED TO.....

DATE PRINTED

167-5957-A

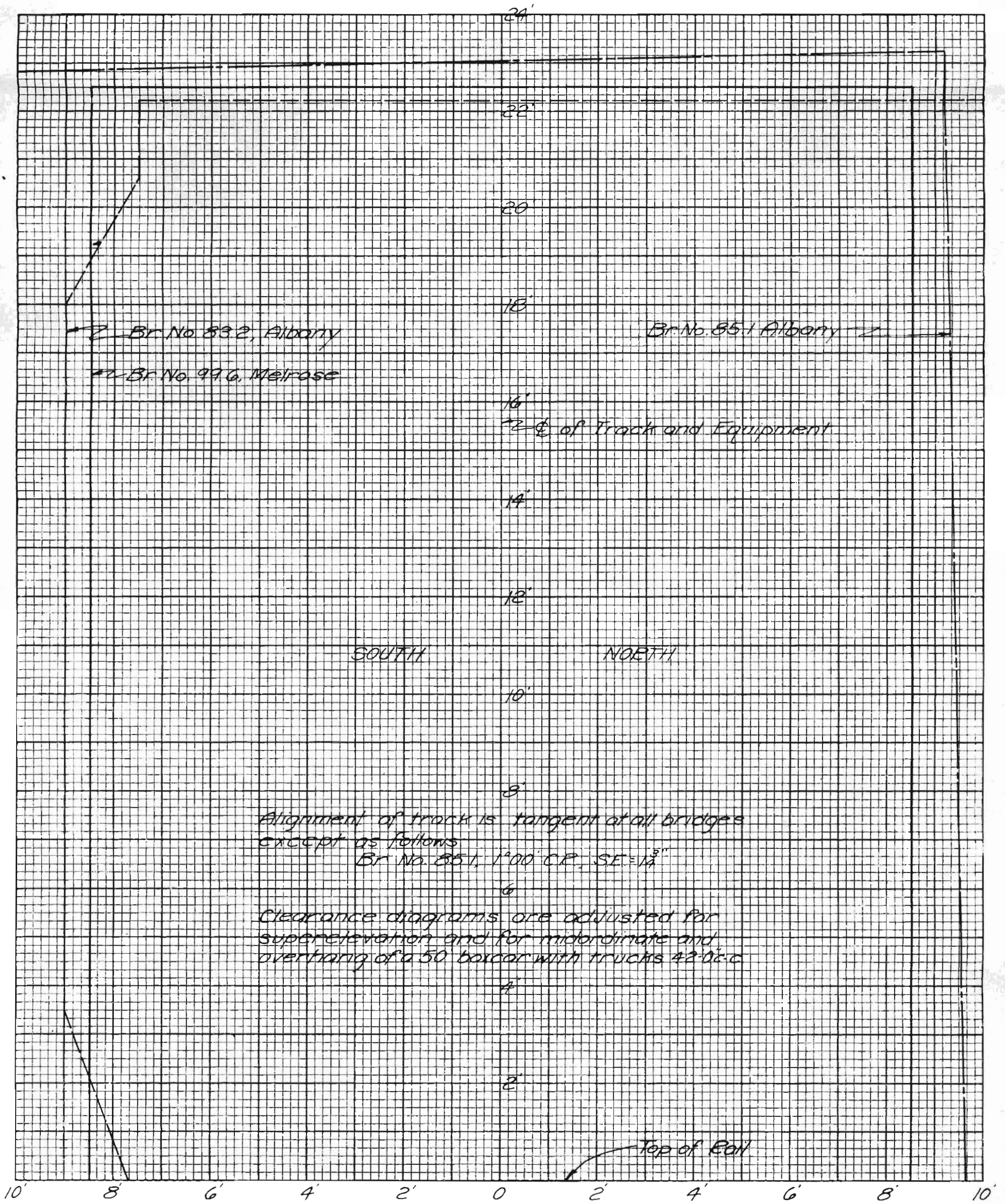

GREAT NORTHERN RAILWAY
 DAKOTA DIVISION
**ST. CLOUD TO SAUK CENTRE
 CLEARANCE DIAGRAM**

OFFICE OF CHIEF ENGINEER, ST. PAUL, MINN.

CORRECTED TO.....

DATE PRINTED

167-5957-1

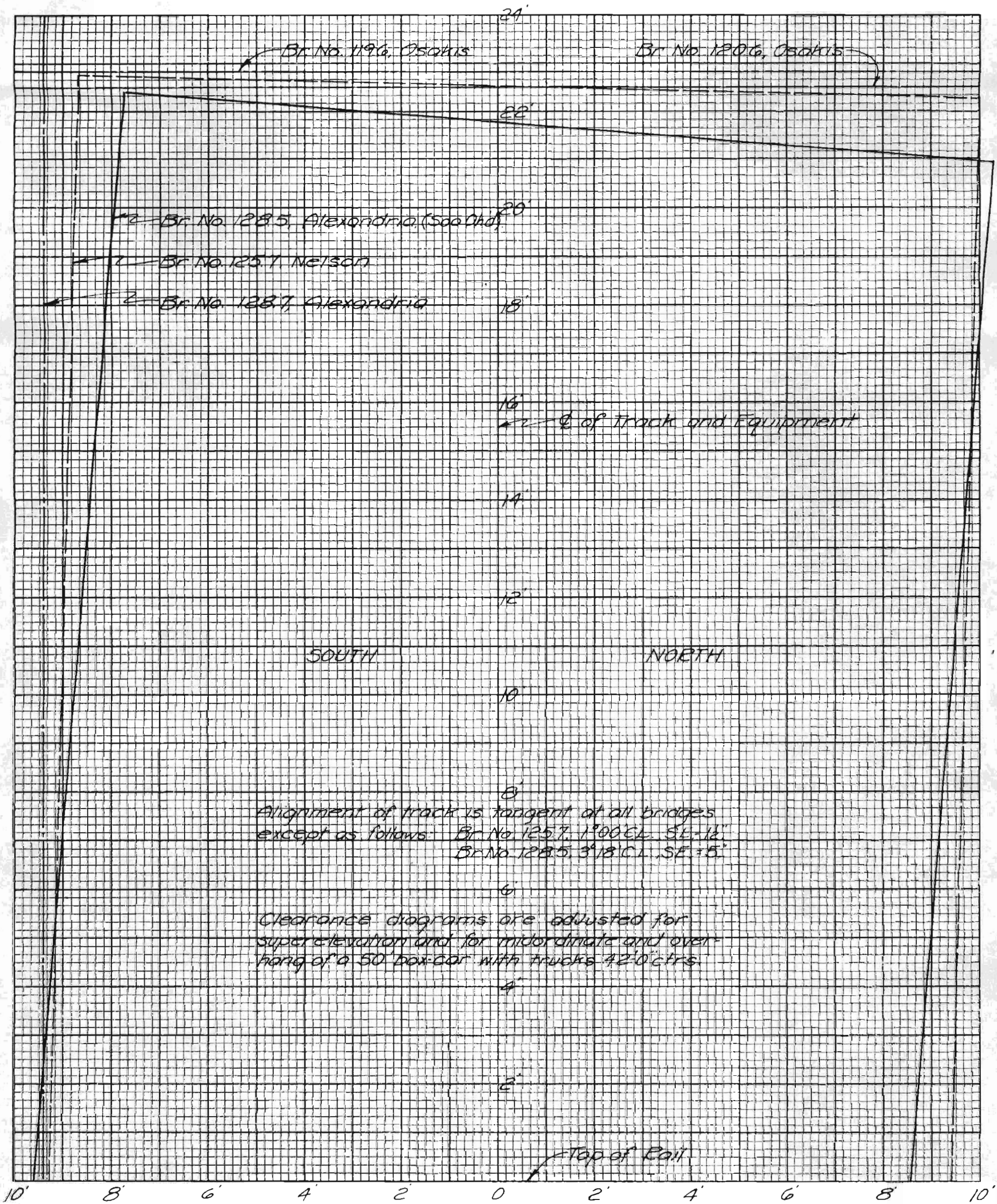

GREAT NORTHERN RAILWAY
DAKOTA DIVISION
**SAUK CENTRE TO ALEXANDRIA
CLEARANCE DIAGRAM**

OFFICE OF CHIEF ENGINEER, ST. PAUL, MINN.

CORRECTED TO Sept 24

DATE PRINTED

167-5957-2

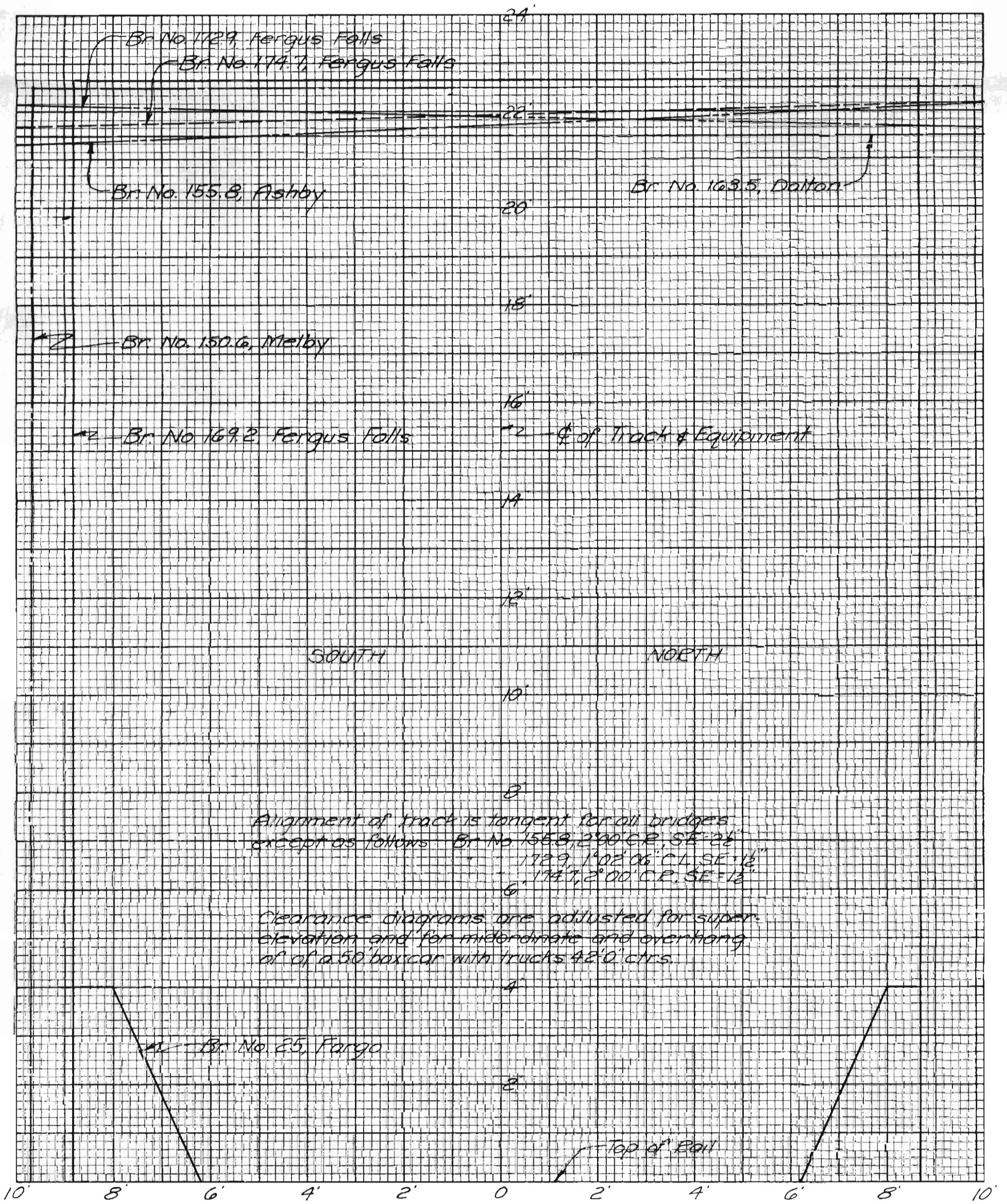

GREAT NORTHERN RAILWAY
 DAKOTA DIVISION
**ALEXANDRIA TO FARGO
 CLEARANCE DIAGRAM**

OFFICE OF CHIEF ENGINEER, ST. PAUL, MINN.

CORRECTED TO.....

DATE PRINTED

167-5957-3

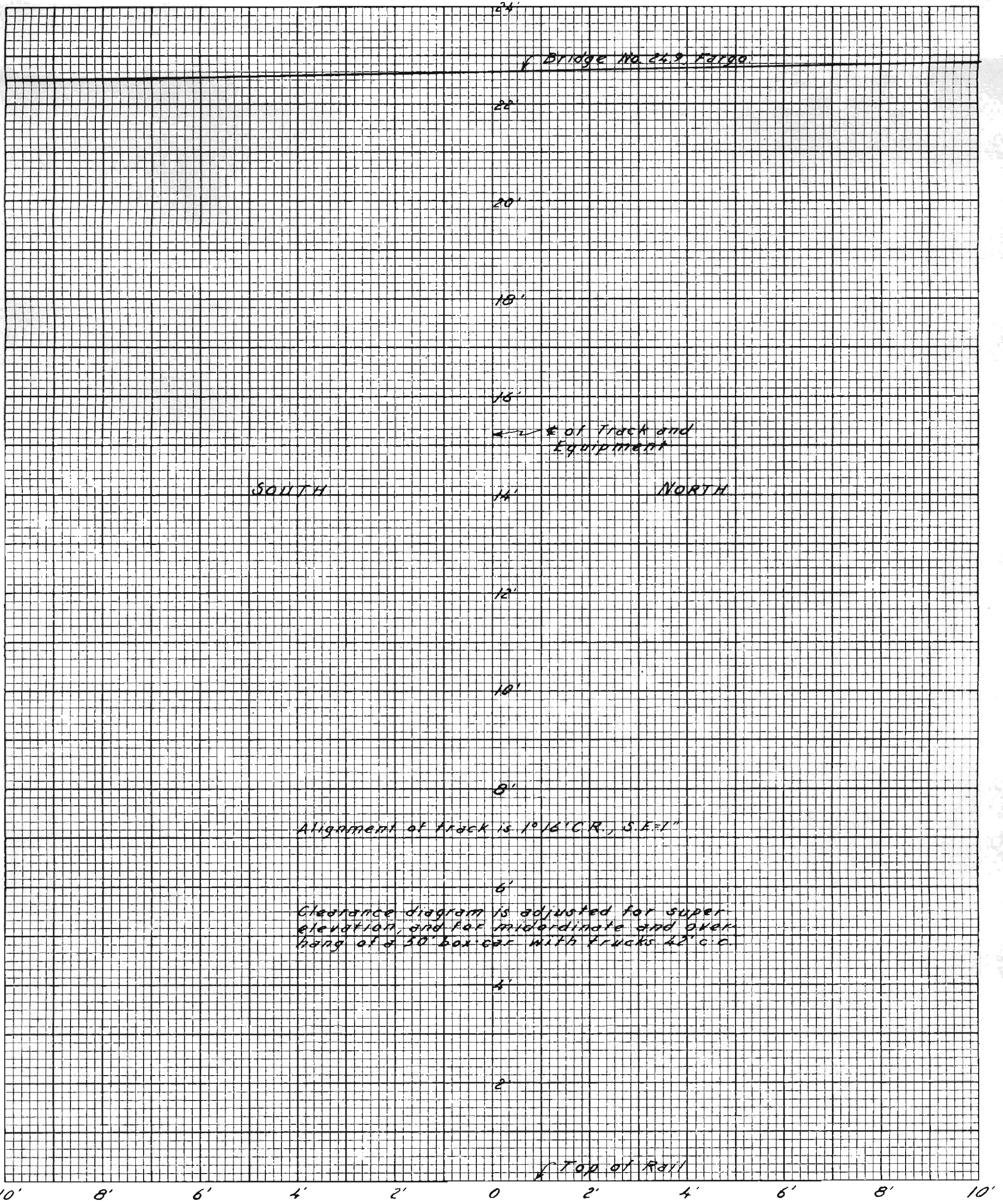

GREAT NORTHERN RAILWAY
 DAKOTA DIVISION
**FARGO TO GRAND FORKS
 CLEARANCE DIAGRAM**

OFFICE OF CHIEF ENGINEER, ST. PAUL, MINN.

CORRECTED TO 11-1-11

DATE PRINTED

167-5957-4

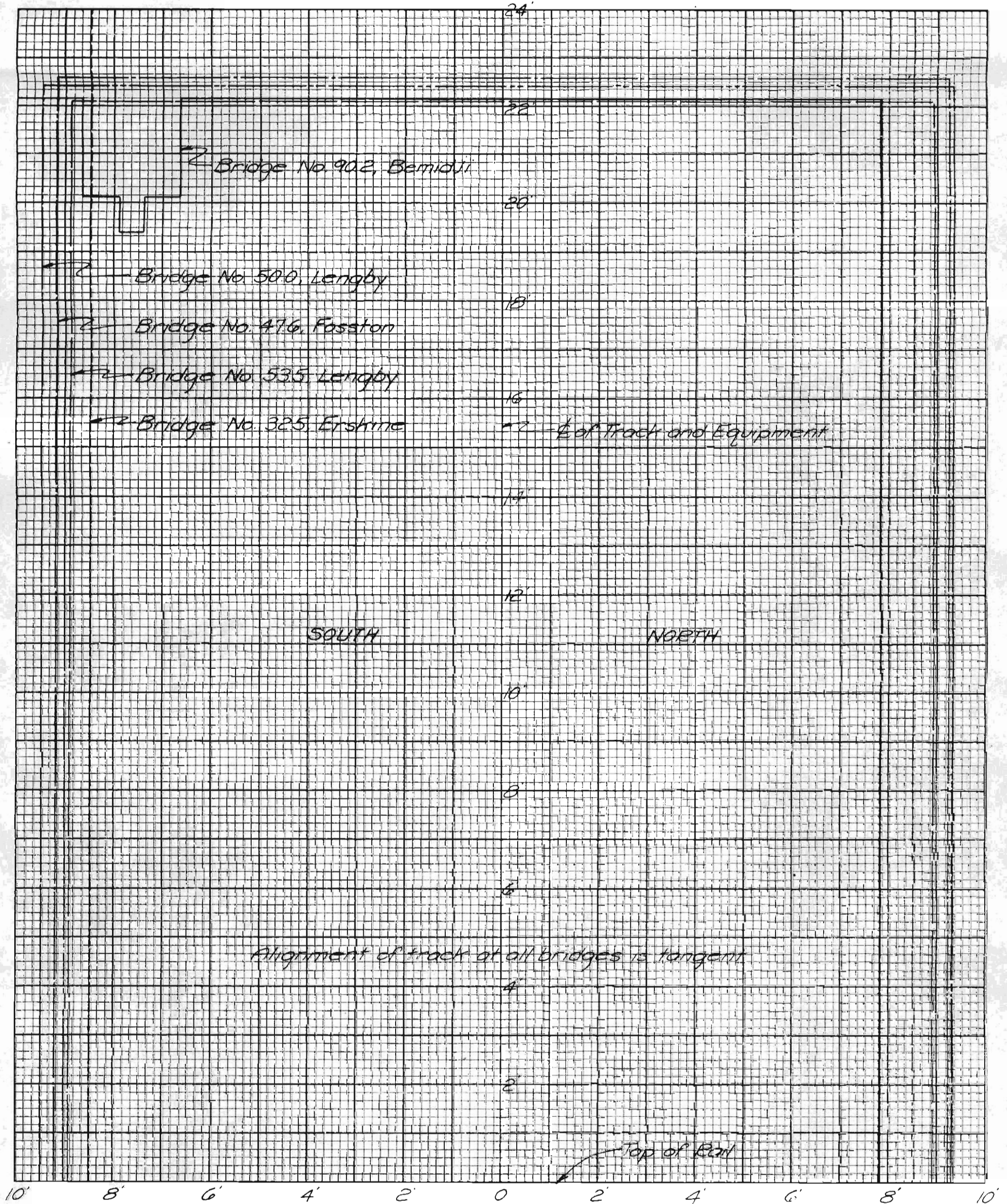

GREAT NORTHERN RAILWAY
DAKOTA DIVISION
**CASS LAKE TO CROOKSTON JCT.
CLEARANCE DIAGRAM**

OFFICE OF CHIEF ENGINEER, ST. PAUL, MINN.

CORRECTED TO

DATE PRINTED

167-5957-5

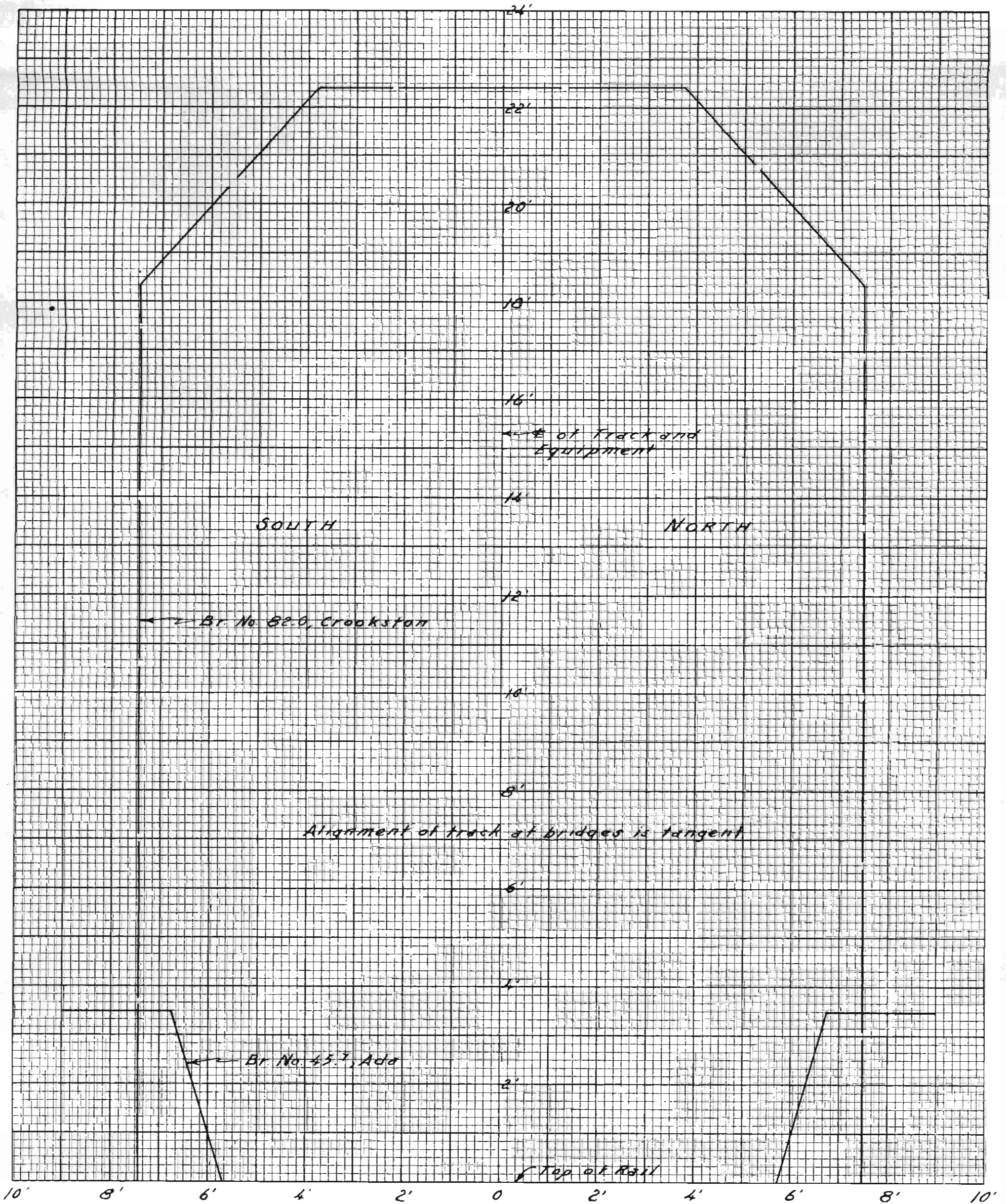

GREAT NORTHERN RAILWAY
DAKOTA DIVISION
**BARNESVILLE TO CROOKSTON
CLEARANCE DIAGRAM**

OFFICE OF CHIEF ENGINEER, ST. PAUL, MINN.

CORRECTED TO

DATE PRINTED

167-5957-6

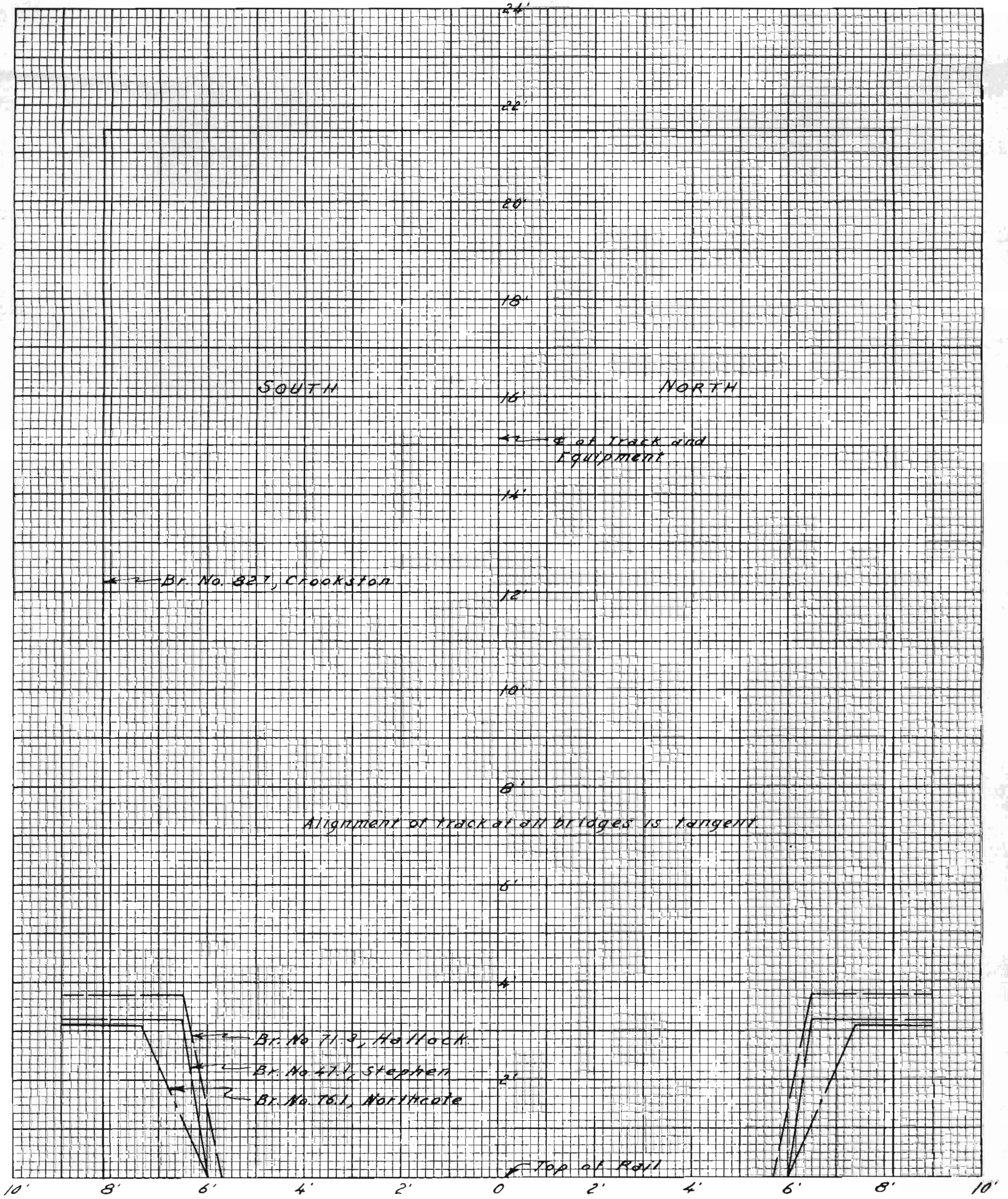

GREAT NORTHERN RAILWAY
 DAKOTA DIVISION
**CROOKSTON TO NOYES
 CLEARANCE DIAGRAM**

OFFICE OF CHIEF ENGINEER, ST. PAUL, MINN.

CORRECTED TO

DATE PRINTED

167-5957-7

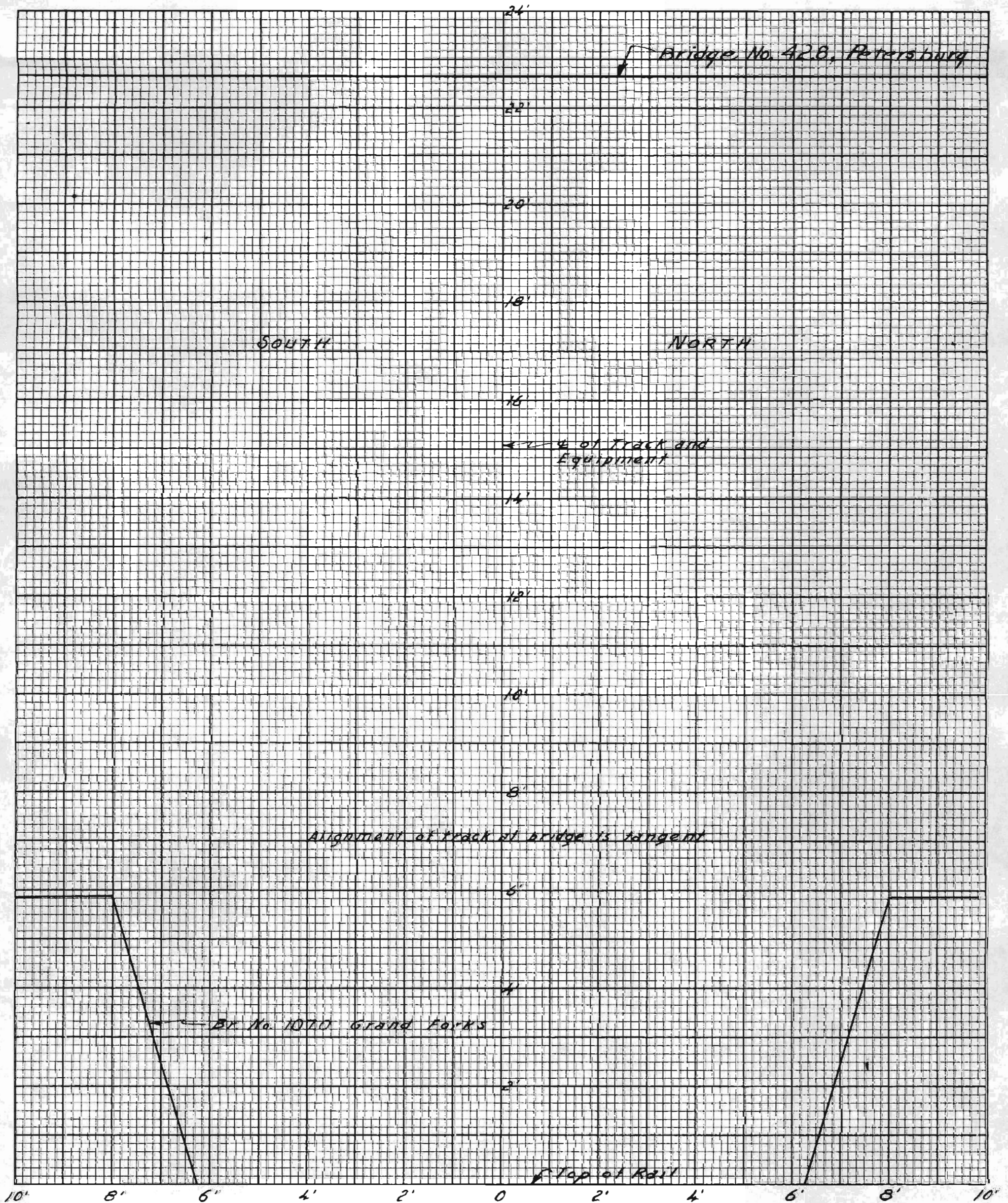

GREAT NORTHERN RAILWAY
DAKOTA DIVISION
**CROOKSTON TO DEVILS LAKE
CLEARANCE DIAGRAM**

OFFICE OF CHIEF ENGINEER, ST. PAUL, MINN.

CORRECTED TO *Sept. 1964*

DATE PRINTED

167-5957-8

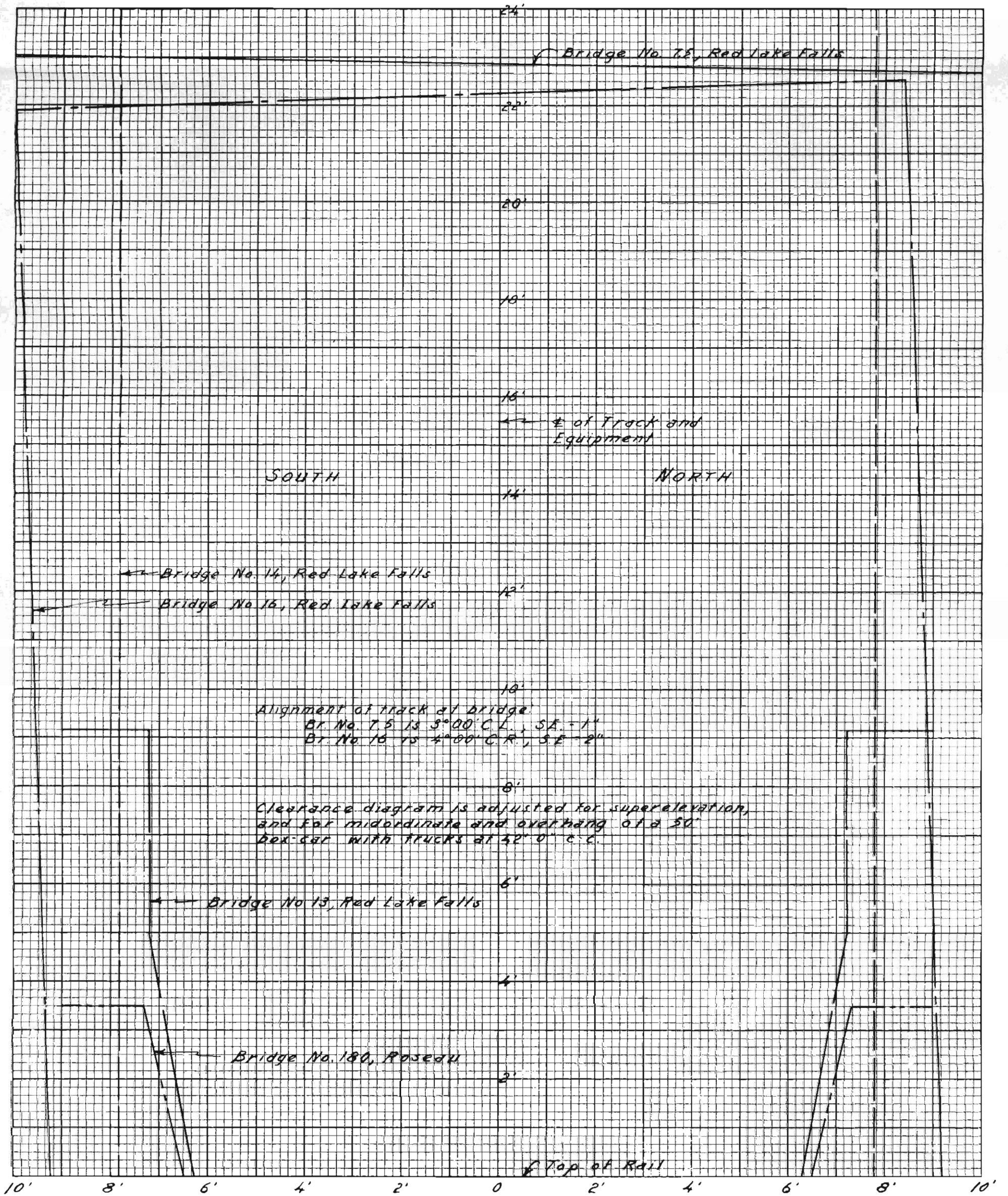

GREAT NORTHERN RAILWAY
 DAKOTA DIVISION
**TILDEN JCT. TO WARROAD
 CLEARANCE DIAGRAM**

OFFICE OF CHIEF ENGINEER, ST. PAUL, MINN.

CORRECTED TO

DATE PRINTED

167-5957-9

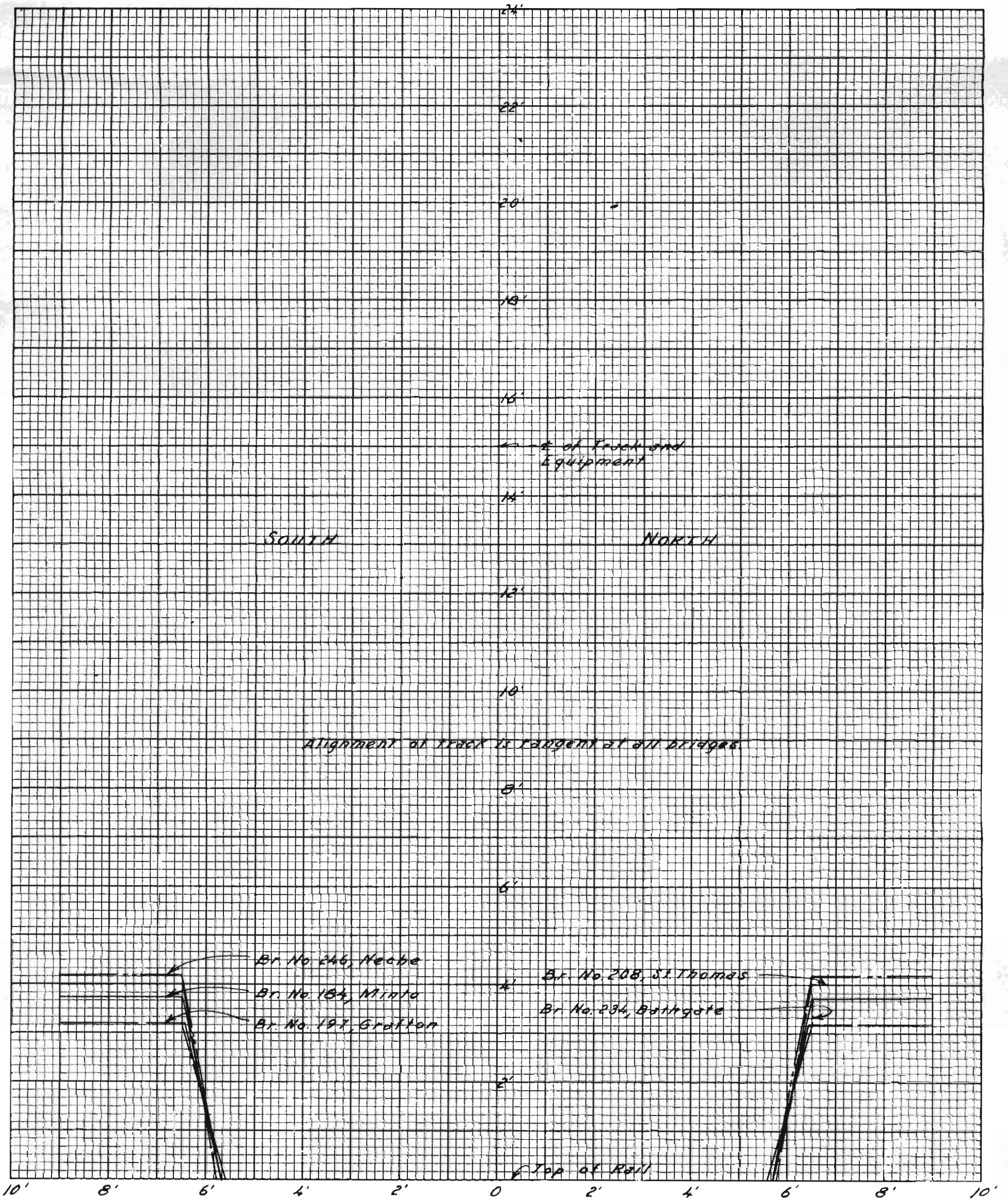

GREAT NORTHERN RAILWAY
 DAKOTA DIVISION
GRAND FORKS TO NECHE
CLEARANCE DIAGRAM

OFFICE OF CHIEF ENGINEER, ST. PAUL, MINN.

CORRECTED TO

DATE PRINTED

167-5957-10

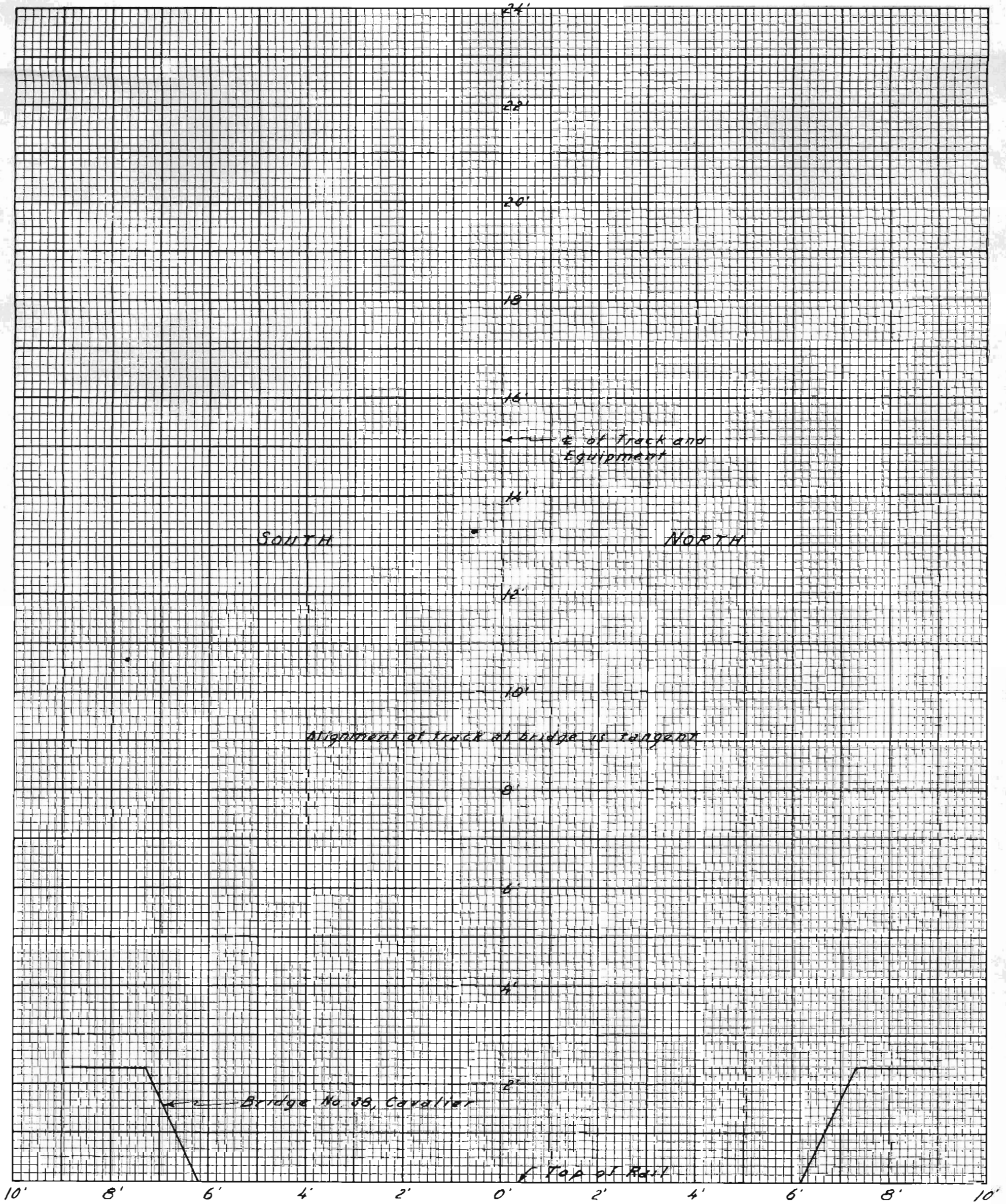

GREAT NORTHERN RAILWAY
 DAKOTA DIVISION
GRAFTON TO WALHALLA
CLEARANCE DIAGRAM

OFFICE OF CHIEF ENGINEER, ST. PAUL, MINN.

CORRECTED TO

DATE PRINTED

167-5957-11

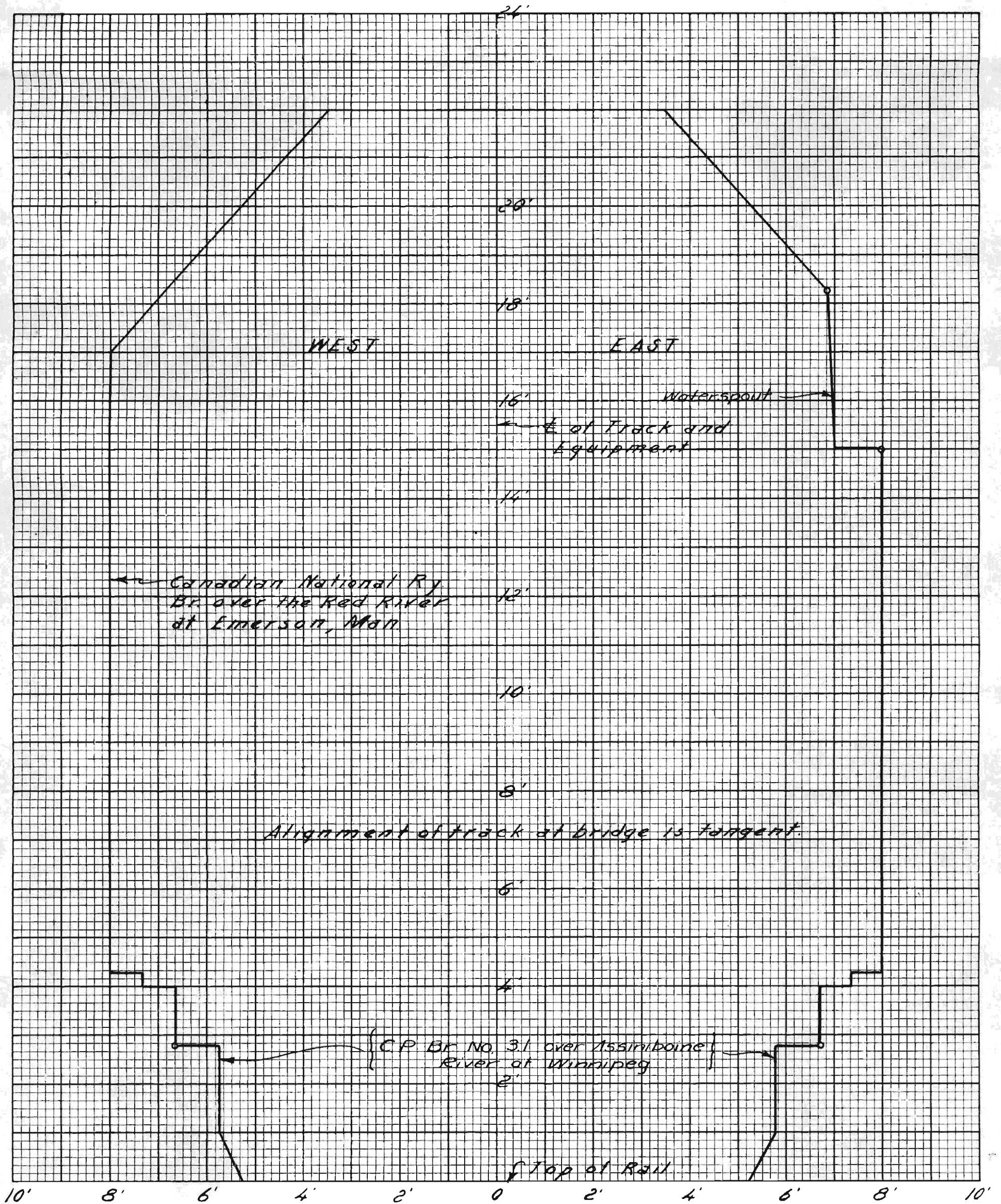

GREAT NORTHERN RAILWAY
 THE MIDLAND RAILWAY CO. OF MANITOBA
 NOYES TO WINNIPEG
CLEARANCE DIAGRAM

OFFICE OF CHIEF ENGINEER ST. PAUL, MINN.

CORRECTED TO Sept 12

DATE PRINTED

167-5957-12